

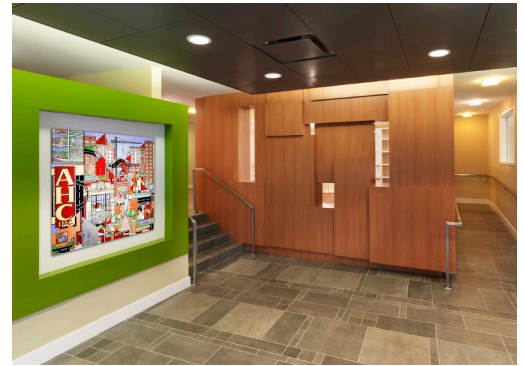

The Jordan
Arlington, VA
97,000 square feet

Multi-Family Residential
Affordable Housing
Underground Parking
EarthCraft Certified

The Jordan solves two urban problems by meeting some of the unmet demand for close-in affordable housing and by bridging different scales of city fabric. More than 80 percent of its 90 units are multi-bedroom apartments for families in need of low-cost housing. At four stories, the brick-clad, stick-framed building mediates between nearby high-rise office buildings and single-family homes in adjoining residential neighborhoods. A landscaped courtyard at its heart provides families with protected outdoor amenity adjacent to a community room and after-school program space. The design team collaborated with local developers, planners, city administrators and consultants to ensure that the project strengthens Arlington's diversity as the neighborhood evolves.



The Jordan
Arlington, VA