

## 3831 Georgia Avenue, NW | Washington, DC

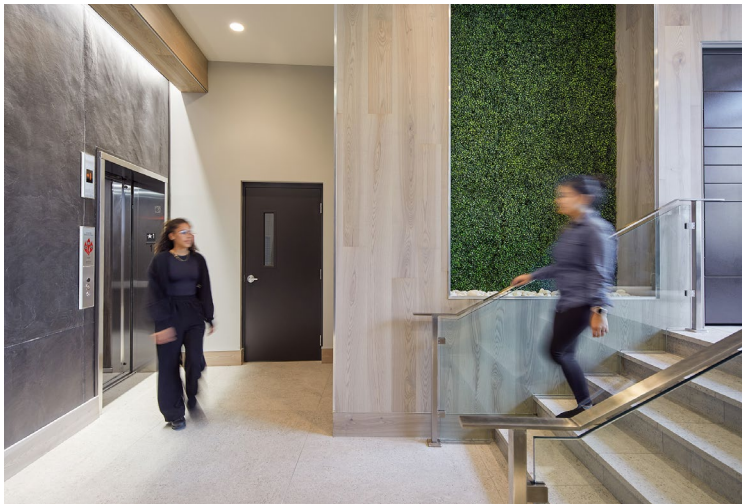

**3831 Georgia Avenue, NW  
Washington, DC**

**31,178 Square Feet**

**Mixed-Use  
Multifamily Residential**

The Augusta at 3831 Georgia Avenue, NW is a 15-unit mixed-use multi-family residential building with street level retail in the Petworth Neighborhood of Washington, DC. Located one block north of the Petworth Metro station, the project will have ground floor retail space and 15 residential units including 3 accessible units. The building comprises five levels of composite steel above a concrete podium. The mixed-use project is designed to promote an active lifestyle for urban dwellers and the use of public transportation in an amenity-rich neighborhood.



3831 Georgia Avenue, NW | Washington, DC

